

Animate Text

- Add text to a slide and click on the “Animation” button

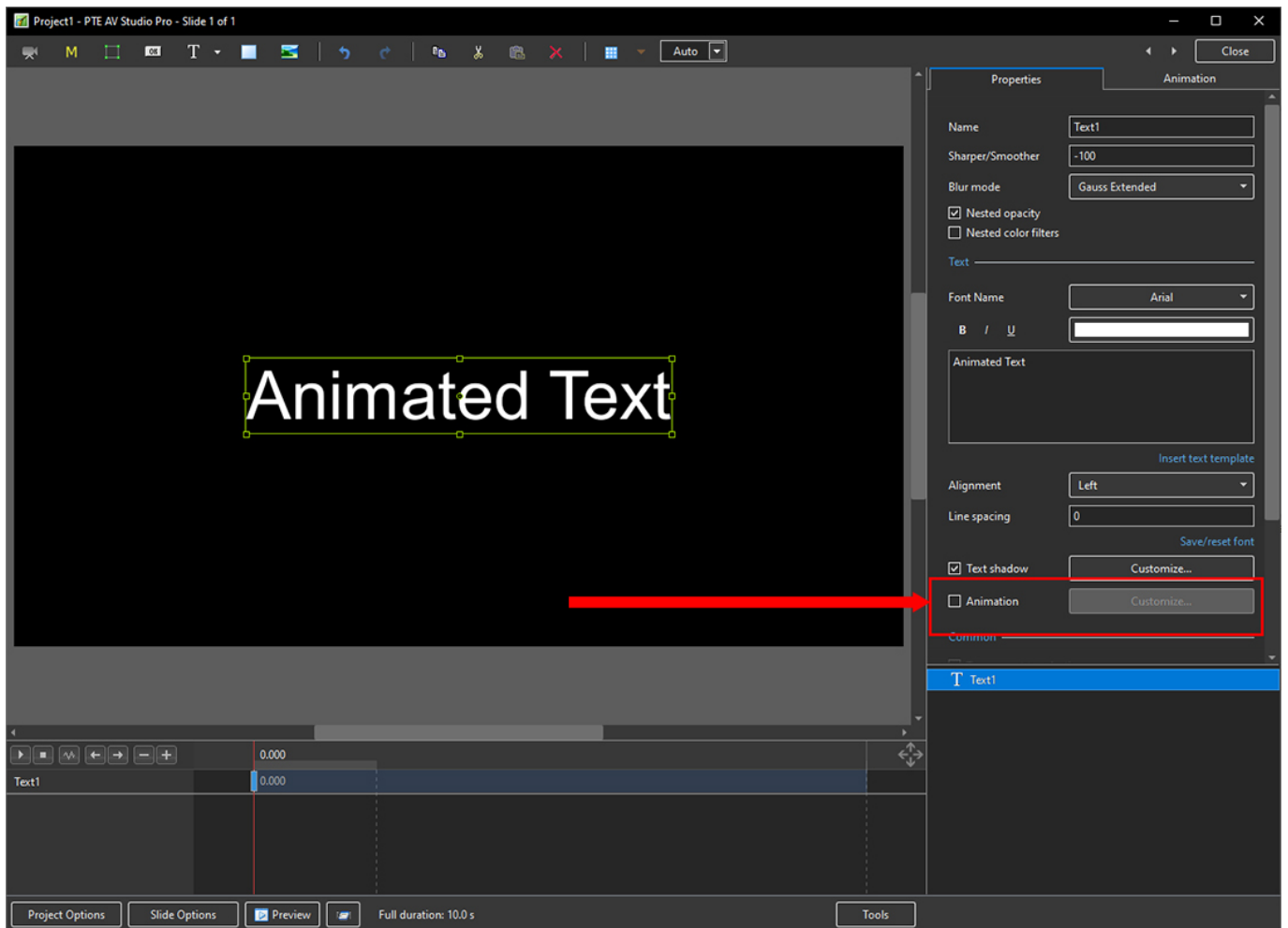

- Then click on “Customise”

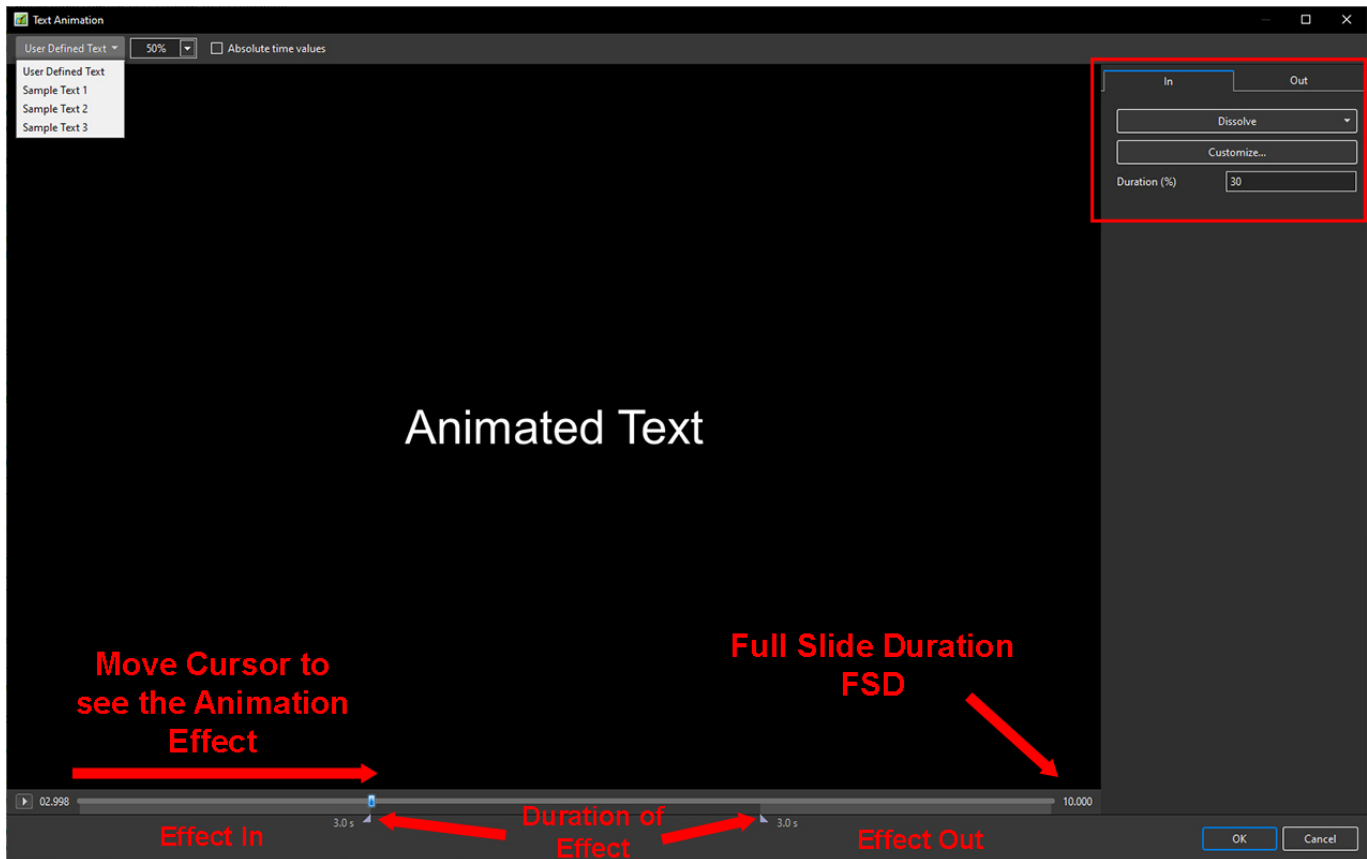

- Choose from User Defined Text or Sample Text
- Vary the size of the Text in the Editor
- Choose Absolute Time Values to ensure the Duration % does not change when Slide Duration is changed
- Drag the Cursor to see the Effect

In the Upper Right Adjustments Panel

The Effect In Tab

- Choose the Effect In Tab
- The Duration adjustment indicates the percentage of Full Slide Duration for the Effect In and Effect Out
- Click on “Dissolve” to see a list of Effects

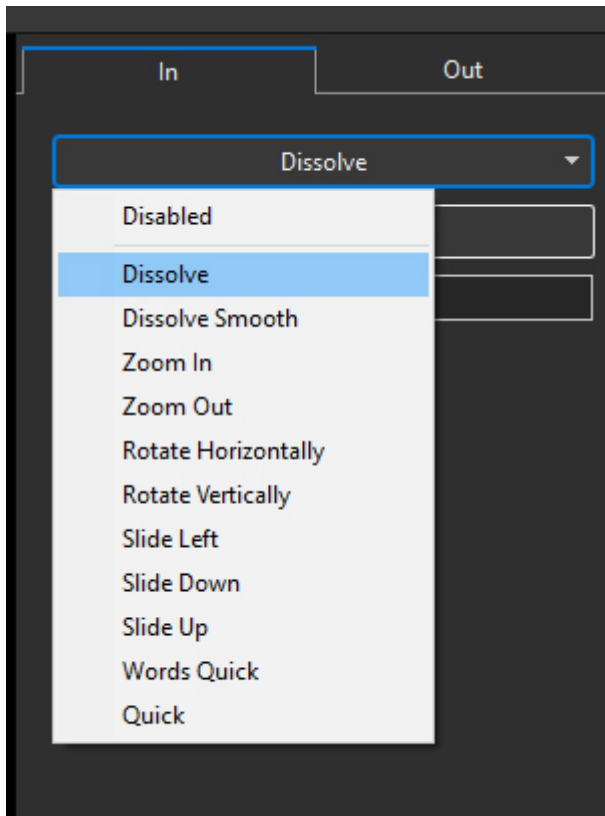

- Choose an Effect and then click on “Customise”

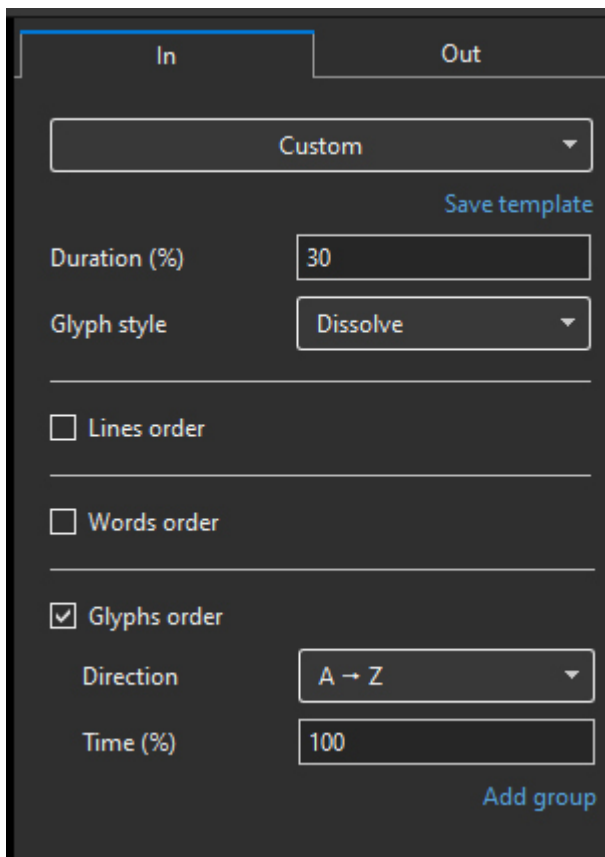

- The Effect Duration % can be adjusted here
- The Glyph (Letter) Style can be adjusted here
- Choose from Lines Order, Words Order **OR** Glyphs Order

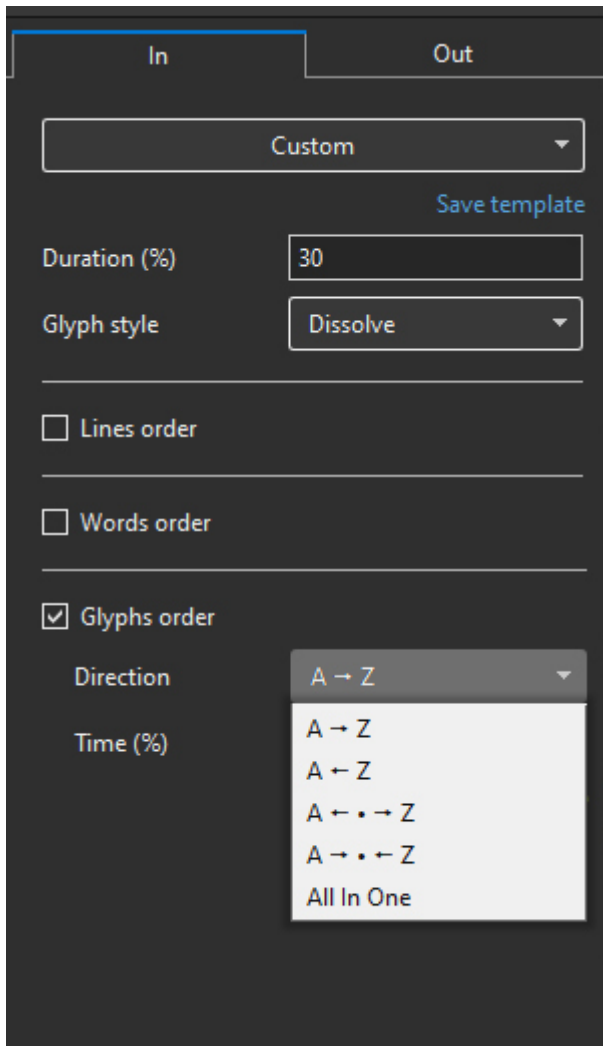

- Choose from the Dropdown Menu
- Drag the Cursor to see the Effect
- The Time % controls the speed of the Effect

- The Words Order Menu is the same as the Glyphs Order Menu
- The Lines Order Menu differs

In Out

Custom

Save template

Duration (%) 30

Glyph style Slide Left

Lines order

Direction First to Last

Time (%)

Words order

Glyphs order

- First to Last
- Last to First
- From Center
- To Center
- All In One

From:
<https://docs.pteastudio.com/> - PTE AV Studio

Permanent link:
https://docs.pteastudio.com/en-us/11.0/how_to_v11/animate?rev=1677676699

Last update: **2023/03/01 13:18**

